

Silverwood Golf Course Clubhouse

Sample Number	Sample Description	Sample Location
A-001	2'x4' Ceiling Tile with Small and Medium Pinholes and Large Divots	Room 104
A-002	Drywall Joint Compound	Room 104
A-003	White Window Caulking	Room 102
A-004	Grey Window Caulking	Room 102
A-005	2'x4' Ceiling Tile with Small and Medium Pinholes and Large Divots	Room 102
A-006	Drywall Joint Compound	Room 102
A-007	2'x4' Ceiling Tile with Small and Medium Pinholes and Large Divots	Room 110
A-008	Drywall Joint Compound	Room 107
A-009	Drywall Joint Compound	Room 106
A-010	Drywall Joint Compound	Room 106
A-011	Grey Duct Mastic	Room 106
A-012	Pipe-Fitting Insulation	Room 106
A-013	Pipe-Fitting Insulation	Room 106
A-014	White Building Caulking	Room 106
A-015	Black Firestop	Room 106
A-016	White Sink Undercoat	Room 105
A-017	Drywall Joint Compound	Room 102
A-018	Drywall Joint Compound	Room 104
A-019	Black Building Caulking	Exterior
A-020	White Firestop	Exterior
A-021	Brown Building Caulking	Exterior
A-022	Black Window Caulking	Exterior

NOTE:
THESE DRAWINGS HAVE BEEN PREPARED
BASED ON INFORMATION PROVIDED BY
OTHERS. THE CITY HAS TAKEN STEPS TO
VERIFY THE ACCURACY AND/OR
COMPLETENESS OF THIS INFORMATION BUT
SHALL NOT BE RESPONSIBLE FOR AND
ERRORS OR OMISSIONS THAT MAY BE
INCORPORATED AS A RESULT OF ERRONEOUS
INFORMATION PROVIDED BY OTHERS THAT
WAS NOT ABLE TO BE VISUALLY CONFIRMED.

- GENERAL NOTES:
1. ALL DIMENSIONS ARE IN MILLIMETRES
 2. DRAWINGS ARE NOT TO BE SCALED.
 3. ALL DRAWINGS TO BE READ IN CON-
JUNCTION WITH THE SPECIFICATIONS
UNLESS OTHERWISE NOTED.
 4. VERIFY SITE CONDITIONS, DIMENSIONS
AND LOCATION OF ALL UTILITIES PRIOR
TO THE START OF CONSTRUCTION.
 5. REPORT ALL DISCREPANCIES TO THE
CONSULTANT.

REV	ISSUED FOR	DATE

DESIGNED BY:	DRAWN BY:	CHECKED BY:	REQUESTED BY:
	MSB		

SCALE:	DATE:
1:75	21/03/2013

SHEET NAME	Asbuilt
Main Floor Base Plan	

PROJECT TITLE
**814
Silverwood
Golf Clubhouse**

PROJECT NO.	SHEET

REV. NO.	

 Asbestos-Containing Drywall Joint Compound

 Asbestos-Containing Drywall Joint Compound and Caulking

 Asbestos-Containing Drywall Joint Compound and Ceiling Tiles

 Asbestos-Containing Drywall Joint Compound,
Ceiling Tiles, and Caulking

 Asbestos-Containing Drywall Joint Compound
and Sink Undercoat

 Asbestos-Containing Drywall Joint Compound,
Duct Mastic, Pipe-Fitting Insulation,
Caulking, and Firestop

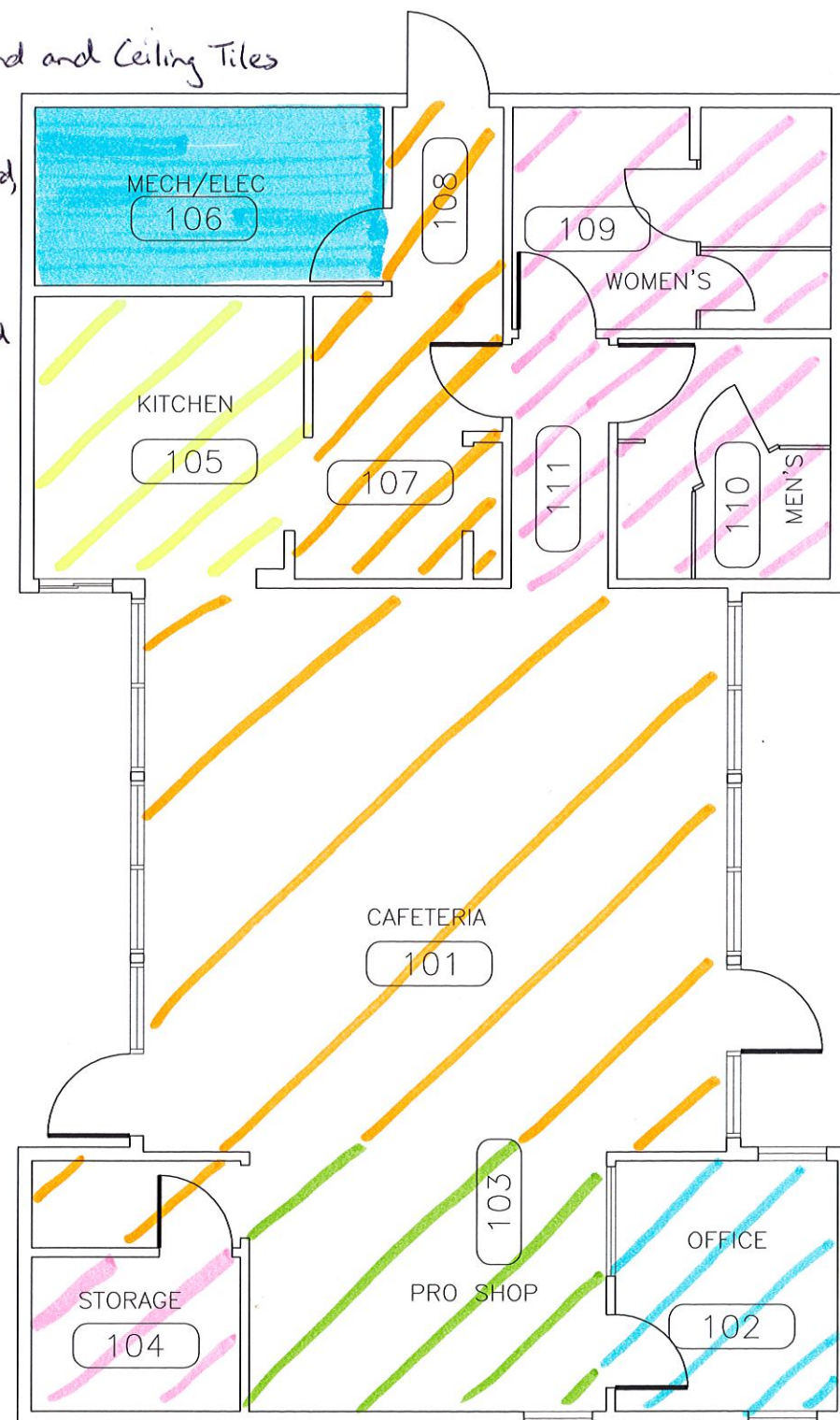

Notes: 1) Asbestos is a carcinogen.
Avoid breathing dust.
2) Asbestos-containing caulking
and firestop are located
on the building exterior.