

HARRY BAILEY AQUATIC CENTRE • 1110 Idylwyld Drive

For bookings and rental rates, call Customer Service at 306.975.3321 or fax 306.975.7947.

Harry Bailey Aquatic Centre is the heart of aquatics for many Saskatoon athletes, with speed swimmers, divers and synchronized swimmers headquartered here. This is also the pool where people can practice kayaking, canoeing and scuba diving in a controlled setting.

The facility's size and versatility make it an ideal spot for large school groups and private rentals. The pool area includes a large competitive pool, diving boards, leisure pool, zero-entry beach area with water bubblers, a challenging climbing wall, hot tubs and sauna. Everyone from toddlers to competitive athletes can find their fit here.

With its location just outside the downtown core, Harry Bailey's meeting room is ideal for business meetings, group training events and clinics.

50-Metre Competitive Pool

- 8, 50 m lanes or 16, 25 m lanes
- 1 & 3 m diving boards
- 5, 7 & 10 m diving platforms (10 m platform not open to the public)
- Shallow end depth of 3 ft (1 m) to 5 ft (1.5 m)
- Deep end depth of 5 ft (1.5 m) to 16 ft (4.8 m)
- Water temperature is maintained at 29°C (84°F)
- Bleacher area seats 500

25-Metre Leisure Pool

- 6, 25 m lanes
- Depth of 4.5 ft to 5.5 ft
- Water temperature is maintained at 30°C (86°F)
- Wheelchair accessible

Tot Pool

- Pool starts at 0-depth to 2 ft
- Attached to the Leisure Pool
- Spray feature
- Water toys available

Meeting Room

- Tables and chairs available
- Flip charts
- TV and DVD player
- Projector



See next page for facility map and room dimensions.





HARRY BAILEY AQUATIC CENTRE • 1110 Idylwyld Drive

For bookings and rental rates, call Customer Service at 306.975.3321 or fax 306.975.7947.

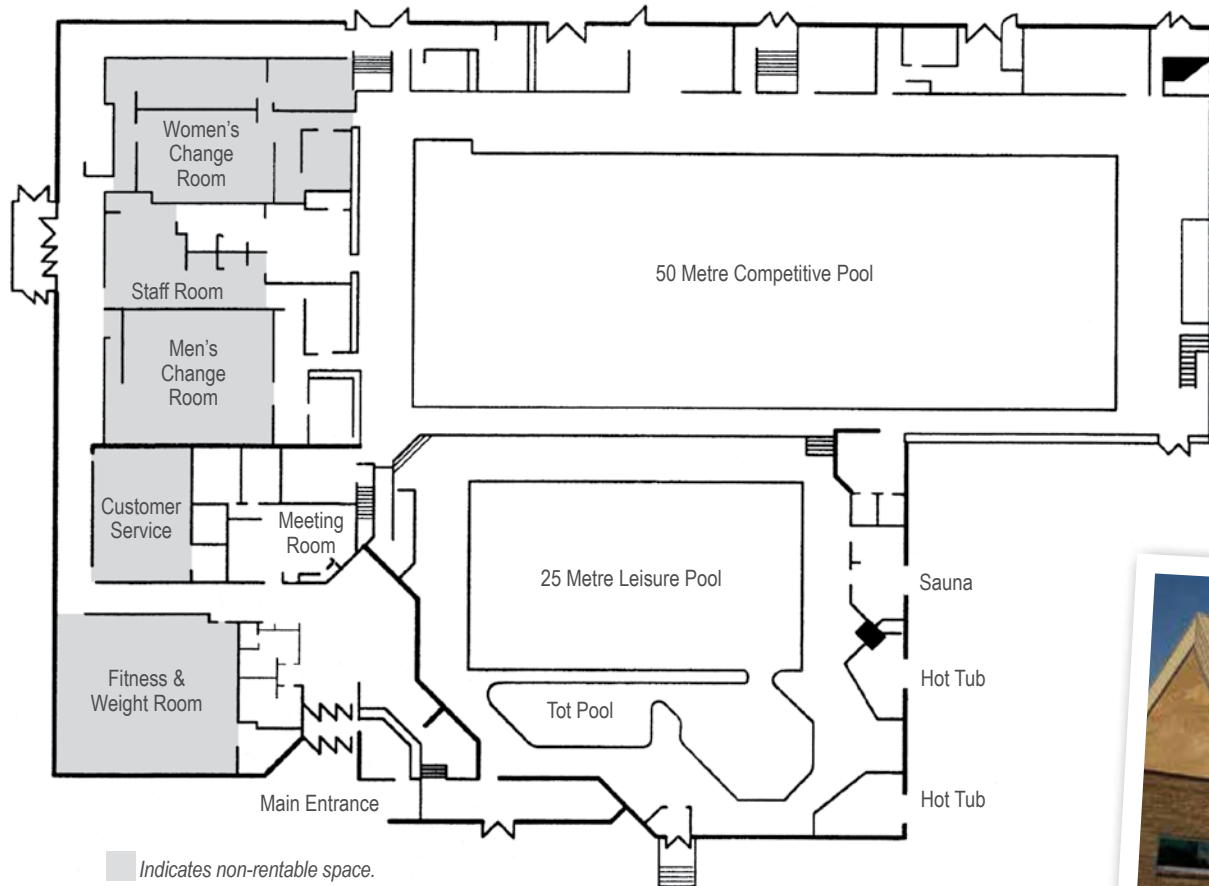

Other features

- Fitness & Weight Room
- Drop-in Fitness Classes (aquatic and dryland)
- Vending Machines



Room	Size	Dimensions	Capacity
Competitive Pool	8, 50 m lanes or 16, 25 m lanes		600
Leisure Pool	6, 25 m lanes		350
Tot Pool	0 depth to 2 ft		
Meeting Room	590 sq ft	22' x 26'	22*

*Capacity is based on standard meeting set-up with tables and chairs.